

# RESILIENT SEAT DOUBLE SOCKET PN16

Version 2.0

Clover Resilient Seat Double Socket Gate Valves are suitable for use in pressure and non-pressure water supply and sewerage applications.

## SPECIFICATIONS

**Diameter Range:** DN80 - DN375

**Nominal Pressure:** 1,600kPa

**End Connections:**

Socket AS/NZS2280 Series 2 seals fitted as standard (Series 1 seals available)

**Maximum Operating Temperature:** 40°

**Product/Watermark Certification:**

Australian Certification Services - 25731

**Compliance:**

- AS/NZS2638.2 "Gate valves for waterworks purposes - Resilient seated"
- AS/NZS4158 "Thermal-bonded polymeric coatings on valves and fittings for water industry purposes"
- AS1646 "Elastomeric seals for waterworks purposes"
- AS1831 "Ductile cast iron"
- AS/NZS4020 "Testing of products for use in contact with drinking water"
- ISO5211 "Industrial Valves - Part-turn actuator attachments"

**WSAA Product Appraisal:** PA11/12

**WSAA Purchase Specification:**

WSA PS260 – Gate Valves, Resilient Seated for Pressure Applications – Water Supply and Sewerage

**Options & Accessories:**

- Anti-clockwise and clockwise closing models available
- Handwheel
- Gearbox Operator (Spur & Bevel)
- ISO5211 Top Mounting Flange
- Anchor legs and valve restraint straps
- Lilac key-cap available for recycled water applications
- Series 1 seals available

**Recommended Specifications:**

- Gate valves shall be Clover resilient seated non-rising spindle type conforming to AS/NZS2638.2
- Gate valves shall close in an anti-clockwise / clockwise direction
- Gate valves shall be fitted with a keycap / handwheel
- Gate valve allowable operating pressure shall be 1,600kPa
- Protective coatings of gate valves shall be thermally applied polymeric type in accordance with AS/NZS4158
- Socket end connections shall be fitted with EPDM seals compatible with Series 2 pipe / Series 1 pipe



## FEATURES

- 10 year manufacturers warranty
- Reduced weight for safe and easy handling
- Low operating torque for fast and efficient operation
- Full bore design eliminates debris build up
- Key cap or handwheel operable
- High strength and impact resistant ductile iron body
- Thermally bonded polymeric coating for long life corrosion protection
- Integrated cast-in foot design provides stability
- Isolated 316SS stainless steel fasteners encapsulated with hot-melt coating for long-life corrosion protection
- Ductile iron wedge encapsulated with vulcanised EPDM elastomer and integrated guide rails
- Forged stainless steel stem with wedge stop and rolled threads for high strength
- Suitable for installation in either horizontal or vertical position

## APPLICATIONS

- Used to isolate flow within pipeline sections, pipeline equipment and offtakes
- Gate valves should not be used for the purposes of throttling or adjusting flow
- Potable and recycled water supply
- Irrigation and raw water
- Gravity and sewer rising mains
- Fire systems
- Stormwater and drainage
- Pressure and non-pressure
- Buried and above ground

# RESILIENT SEAT DOUBLE SOCKET PN16

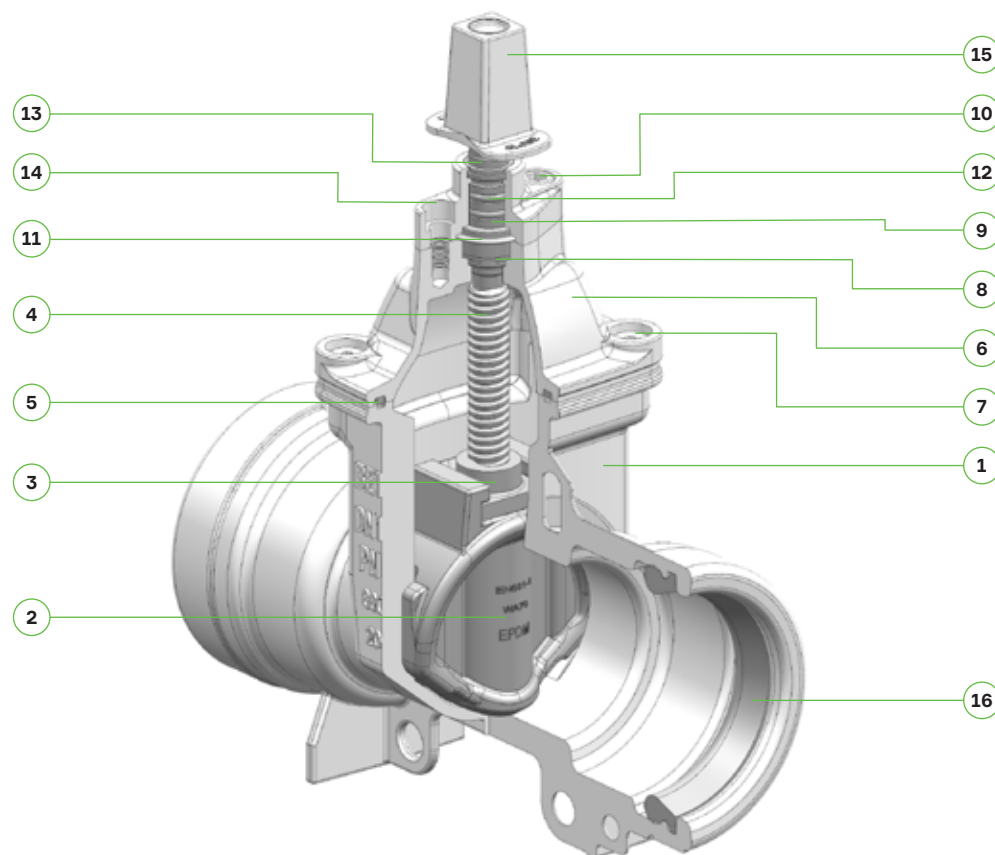

## COMPONENTS

ITEM	PART NAME	MATERIAL	STANDARD/GRADE
1	Body	Ductile Iron/Polymeric Coating	AS1831 500-7/AS4158
2	Wedge	Ductile Iron (EPDM Encapsulated)	AS1831 500-7/AS1646 EPDM
3	Stem Nut	Aluminium Bronze	DN80 – DN200 AS1568 C48600
		Copper Alloy (Dezincification Resistant)	DN225~375 AS1565 C95210
4	Spindle	Stainless Steel 431	ASTM A276/431
5	Body Gasket	EPDM Elastomer	AS1646/EPDM
6	Bonnet	Ductile Iron/Polymeric Coating	AS1831 500-7/AS4158
7	Body Bolt	Stainless Steel 316	ASTM A276/316
8	Thrust Washer	POM	
9	Thrust Collar	DN50-300 POM. DN375+ (Dezincification Resistant)	AS1568 C48600
10	Bonnet Bolt	Stainless Steel 316	ASTM A276/316
11	O'Ring	NBR Elastomer	AS1646/NBR
12	Seal Kit	NBR Elastomer	AS1646/NBR
13	Dust Cover	EPDM Elastomer	AS1646/EPDM
14	Seal Retainer Housing	Stainless Steel 316	ASTM A276/316
15	Spindle Key Cap	Ductile Iron	AS1831 500-7
16	Pipe Seal	EPDM Elastomer	AS1646/EPDM

# RESILIENT SEAT DOUBLE SOCKET PN16

SPECIFICATIONS	SYM	UNITS	DN80	DN100	DN150	DN 200	DN 225	DN250	DN300	DN375
LENGTH	L	mm	380	342	372	556	477	482	520	600
HEIGHT (CENTRE TO KEYCAP)	H	mm	310	340	450	580	670	670	780	940
SOCKET DEPTH	S	mm	120	100	105	170	135	144	146	172
WEIGHT OF UNIT (KEYCAP FITTED)		kg	19	24	45	68	90	95	140	249
TURNS TO CLOSE (APPROX)		Turns	21	21	32	35	43	43	44	55
ACTUAL TORQUE TO SEAL (APPROX)		Nm	55	60	110	140	160	160	180	310
MAXIMUM OPERATING TORQUE	MOT	Nm	75	100	150	200	200	250	300	500
ISO5211 TOP MOUNTING FLANGE			F10	F10	F10	F14	F14	F14	F14	F14/F16
PRODUCT CODE (ANTI-CLOCKWISE CLOSE)			VGSS080	VGSS100	VGSS150	VGSS200	VGSS225	VGSS250	VGSS300	VGSS375
PRODUCT CODE (CLOCKWISE CLOSE)			VGSS080C	VGSS100C	VGSS150C	VGSS200C	VGSS225C	VGSS250C	VGSS300C	VGSS375C

All dimensions are in millimetres.

PRESSURE	SYM	UNITS	
PRESSURE NOMINAL	PN	Nom	16
ALLOWABLE OPERATING PRESSURE	AOP	kPa	1,600
MAXIMUM ALLOWABLE OPERATING PRESSURE	MAOP	kPa	1,920
ALLOWABLE SITE TEST PRESSURE	ASTP	kPa	2,000
PRODUCTION TEST - BODY		kPa	2,400
PRODUCTION TEST - SEAT		kPa	1,760

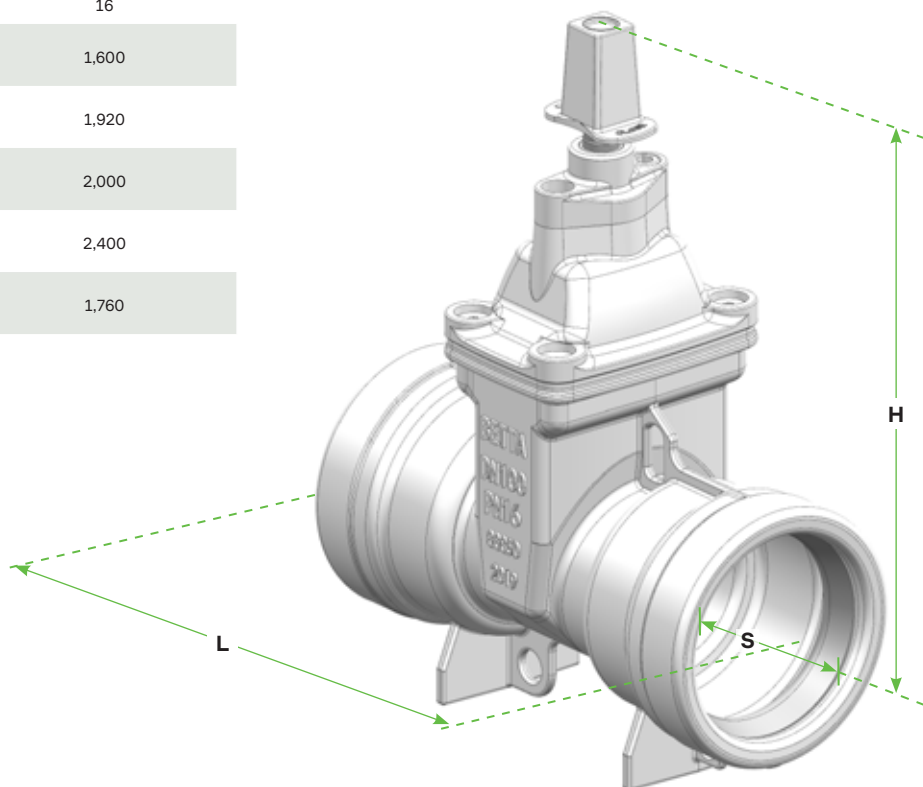

The products shown form part of our continuous improvement program and as such the product designs, specifications and materials may be changed without notice. All warranties relating to accuracy, completeness, or suitability for any particular purpose and all liability for any loss, damage or costs incurred relating to the use of this information are excluded.