

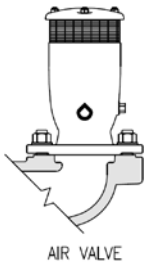

Clover isolation valves provide Isolation of hydrants and air valves for safe and easy maintenance.

Features

- > High strength and impact resistant ductile iron body.
- > Thermally bonded polymeric coating for long life corrosion protection.
- > Outlet flange to DN80 or DN100 AS 4087 Fig. B5 or B6
- > Inlet flange universally slotted to DN80/100 AS 4087 Fig. B5 or B6.
- > Versatile design suitable for a wide range of applications.



Applications

Isolation of hydrants and air valves for maintenance purposes. Suitable for above and below ground potable, non potable and wastewater applications.

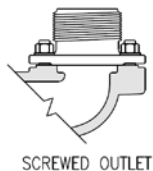

Technical Data

Size Range:	DN80-DN1000
Allowable Operating Pressure:	1600kPa & 3500 kPa
Maximum Temperature:	Valve designed for use up to 70° For AS 4020 compliance, max temp = 40°C
Connections:	Flange AS4087 Fig B5 & B6
Certifications:	AS/NZS4020 AS/NZS4158

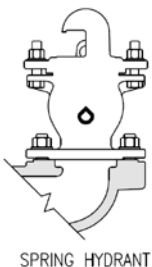

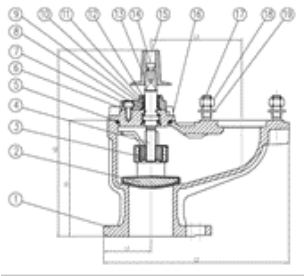

INLET FLANGE
(DN80/DN100 AS4087-B5)

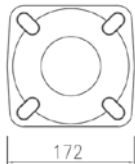

OUTLET FLANGE
DN80 or DN100 AS4087-B5

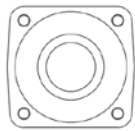

INLET FLANGE
(DN80/DN100 AS4087-B6)

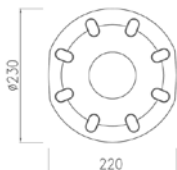

OUTLET FLANGE
DN80 or DN100 AS4087-B6

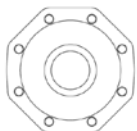

Components

Item	Part Name	Material
1	Body	Ductile iron 500/7 Fusion coat AS4158
2	Stopper Core	Cast Iron WCB
3	Stopper Rubber	EPDM AS1646
4	Stopper Nut	DP Copper Alloy AS1568 C48600
5	Stern	431SS ASTM A276
6	"O" Ring	NBR AS1646
7	Body Bonnet Bolt	316SS ASTM A276
8	Top Bonnet Bolt	316SS ASTM A276
9	"O" Ring	NBR AS1646
10	"O" Ring	NBR AS1646
11	Brushing	DR Copper Alloy AS1568 C48600
12	Spindle Seal Retainer	316SS ASTM A276
13	Dust Proof Cover	EPDM AS1646
14	Stern Cap	Ductile Iron BS500/7
15	Stern Cap Bolt	316SS ASTM A276
16	Plastic Cap	HDPE
17	Bonnet	Ductile iron 500/7 AS1831 Fusion coat AS4158
18	Stud Bolts	316SS ASTM A276
19	Washer	316SS ASTM A276
20	Hex Nut	316SS ASTM A276

PN16 - AS4087 Fig. B5

Outlet	Inlet	L1	L2	H1	H2	PCD	Kg	ACC	CC
80	80/100	86	323	210	336	146	18	VHC080	VHC080C
100	100/100	86	336	210	336	178	20	VHC100	VHC100C

Flanges to AS4087 Fig B5 PN16

PN35 - AS4087 Fig. B6

Outlet	Inlet	L1	L2	H1	H2	PCD	Kg	ACC	CC
80	80	103	370	210	336	165	23	VHC080.35	VHC080C.35
100	100	115	395	210	336	191	27	VHC100.35	VHC100C.35

Flanges to AS4087 Fig B6 PN35

All dimensions are quoted in millimetres. All weights are approximate.

Spring hydrants, air valves and spindle extensions available for all valves.